

**INSTALLATION INSTRUCTIONS**

1. ENSURE THE APERTURE IS CLEAN AND FREE OF DUST AND DEBRIS.
2. THE APERTURE MUST BE FULLY LINED.
3. APPLY A BEAD OF RYANFIRE MASTIC TO THE INTERNAL LINING OF THE APERTURE.
4. SELECT THE CORRECT WIDTH OF RYANSPAN REQUIRED FOR THE GAP.
5. COMPRESS THE RYANSPAN AND FIT CENTRALLY WITHIN THE GAP.
6. TO JOIN TWO PIECES OF RYANSPAN, APPLY RYANFIRE HP-X TO EACH END AND BUTT THEM UP AGAINST EACH OTHER. ENSURE A TIGHT FITTING SEAL.

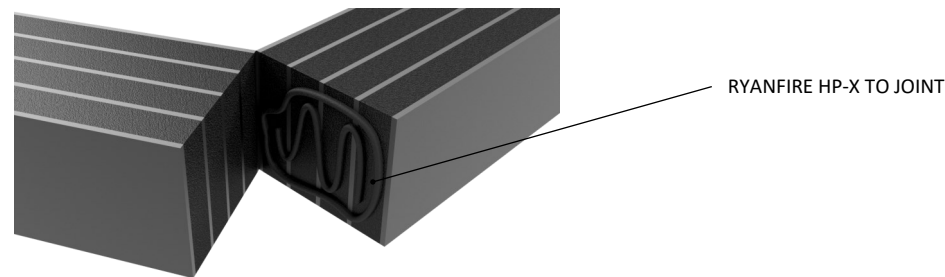
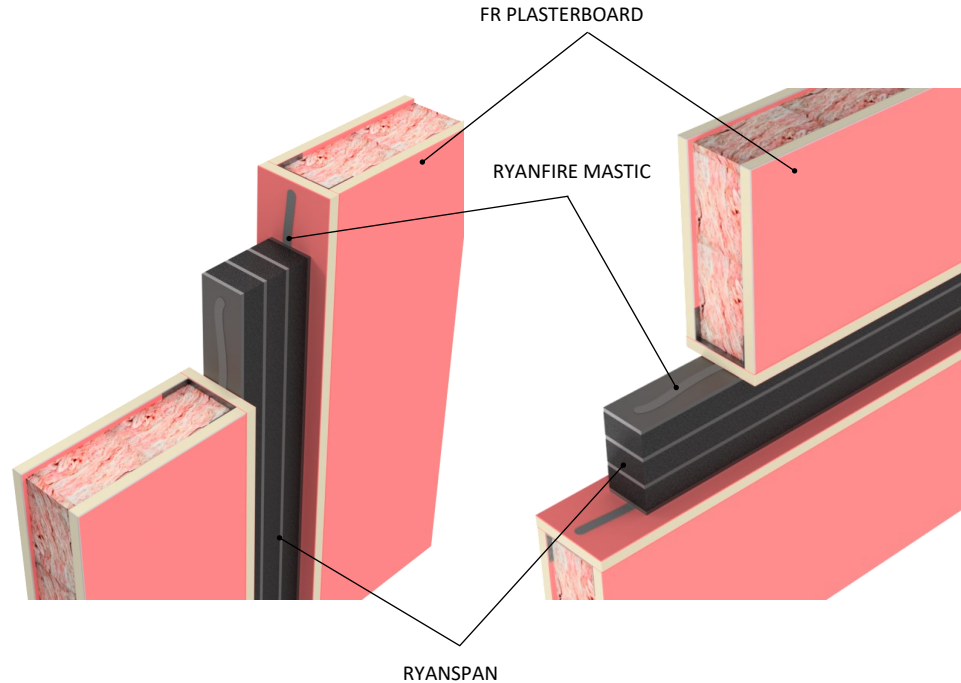

**Products:** RYANSPAN  
RYANFIRE MASTIC  
RYANFIRE HP-X

**Approvals:** AS 1530.4/AS 4072.1

**BK:** 82 / 118 / 121 / 137

**Ref:** 22SFR00013 / 22SFR00023 / 22SFR00032

**ID:** A, B / C, D / A, C, E

**Scenario:** Vertical linear gap seal

**Construction:** 102mm FR Plasterboard / Masonry wall  
Fully lined aperture

**Void Size:** Up to 100mm wide

**Fire Resistance:**

Gap	Vertical	Horizontal
25mm	-/120/90	
50mm	-/120/90	-/120/90
75mm	-/120/90	-/120/90
100mm	-/90/90	-/90/90

Web based drawings are for example only. Fire performance of any system is dependant on, but not limited to size of opening, substrate, if penetrations are passing through, type, size and number. Please refer to Ryanfire technical department for detailed and specific fire performance information.



Client

Job Title

Drawing Title  
**Ryanspan linear gap seal  
102mm plasterboard wall**

Scale: **NTS** Date: **Spetember 2022**

Sheet Size: **A3** Drawn By

Drawing Number: **V67.1** Rev: **4.0**

**Please note:**  
Ryanfire Products Ltd owns and has copyright in these drawings. They are to be used only for the purpose for which they were intended and supplied and are not to be sold, transferred or made available for use by a third party.  
  
Any misuse of these drawings will result in legal proceedings.

**All errors and omissions excepted** - the Information contained within this drawing is believed to be correct on the date of publication, and is based upon tested and certified solutions. The policy of **RyanFire Products Ltd** is one of constant improvement. Installers must therefore ensure that they are following the latest published drawings, test evidence and instructions. Whilst **RyanFire Products Ltd** will endeavour to keep its publications up to date, the accuracy of the information contained within this drawing may be affected by pertinent changes in the law or regulatory requirements and alterations or amendments to the specification of the **manufactured** products. Terms and conditions of sale apply.

RYANFIRE Technical Support: info@ryanfire.co.nz - Tel: 09 443 0362